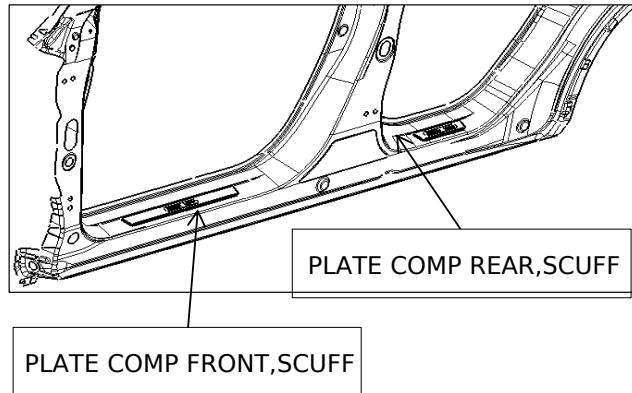

**General View****FOR YOUR SAFETY ( Read carefully )****Introduction of Symbol Messages**

These symbol warn you about the possible hazards and explain how to avoid them. And give you some advices.

**▲ DANGER**

You will be killed or seriously hurt if you do not follow the instructions.

**▲ WARNING**

You can be killed or seriously hurt if you do not follow the instructions.

**▲ CAUTION**

You can be hurt if you do not follow the instructions.

**NOTICE**

Gives advice to prevent damage to the product.  
Gives helpful information or instructions to be followed in using the product.



Indicates prohibited actions.

PLATE COMP FRONT & REAR,SCUFF	<i>HR-V MUGEN</i>
-------------------------------	-------------------

## Introduction of Icons

- These icons indicate the working place and the worker's vision.



The place for the vehicle.

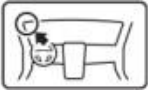

The place for the instrument panel.

- These icons indicate the necessary things for your safety and the work.



Wear eye protection.



Wear heavy gloves.



Work with an assistant.



Place the part on a blanket.



Remove any burrs.



Use the touch-up paint and dry.



Keep the parts and give it to the customer.  
(Not use.)



Press firmly.



Tighten by specified torque.



Work perpendicularly.



Clean with the contact cleaner.

## Safety : General

- Observe all safety notes and precautions described in the Shop Manual in addition to those described in this Installation Instructions. Be extremely careful for your safety of others particularly.
- Be careful not to damage the vehicle and the parts.
- Be extremely careful to the handling of the retaining tabs and clips particularly.
- Note the locations of the parts before removing them so that they can be reinstalled in their original positions properly.

## Safety : For the Accessory

- Always use the parts and tools specified in the Installation Instructions.
- Do not perform installation work and attaching work at the place where gets the direct rays of the sun or the dust appears.
- Always install these accessories at the ambient air temperature 15°C or above.
- Heat the accessories and bonding surfaces if the ambient air temperature is below 15°C.
- Attach the accessories by pressing it firmly with the palm of your hand. Be careful not to damage the accessories and the vehicle parts.
- Carefully place the double-sided adhesive tape on the proper position. Once the double-sided adhesive tape touches the surface, do not try to detach and relocate it. If you attempt to move after it touches the surface, you will damage the part before the adhesive will give away.
- Not to wash the vehicle for 24 hours to allow the adhesives to cure.

PLATE COMP FRONT & REAR,SCUFF	HR-V MUGEN
-------------------------------	------------

**PARTS LIST**

PLATE COMP FRONT,SCUFF

PLATE COMP REAR,SCUFF

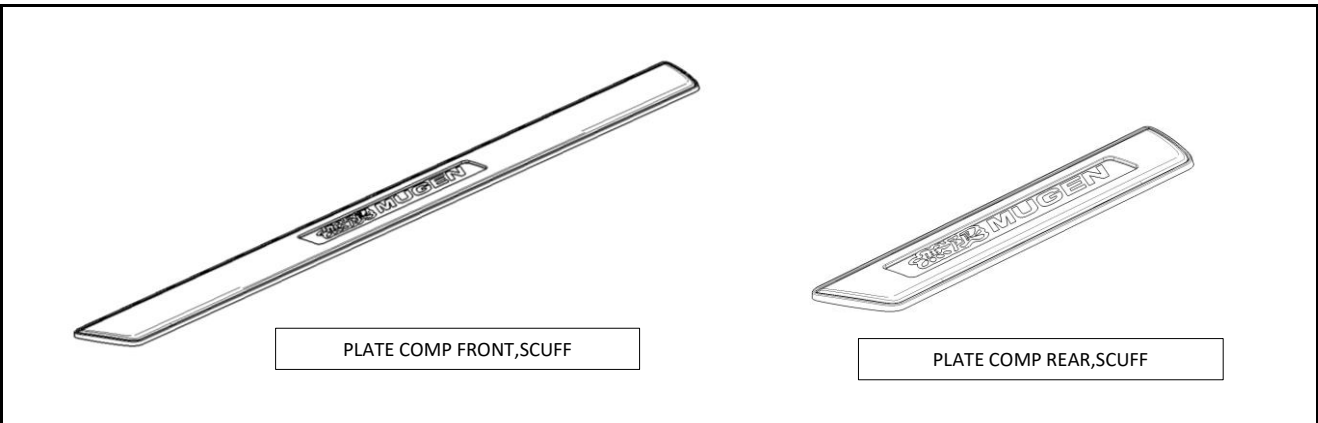

**Reuse Components**

None

**TOOLS AND SUPPLIES REQUIRED**

- Clean Cloth
- Wash Benzene
- Masking Tape
- Ruler

**How to use the Contact Cleaner**

- Using wash benzene on a clean cloth, thoroughly clean the areas where the accessories will be attached.

<b>Notice</b>
<ul style="list-style-type: none"> <li>• Always use the Wash Benzene</li> <li>• Do not apply the cleaner to the object of the work directly.</li> <li>• Completely dry the cleaned areas before attachment work.</li> </ul>

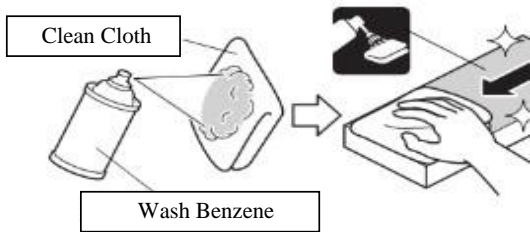

## INSTALLATION

### □ Preparation for install

- Keep away parts and unit side part from scratch.
- Way to install part are the same between Left side and Right side.

<p>1. Clean up surface OEM side body panel with use clean cloth &amp; wash benzene from dust and oil.</p> <p><i>1. Bersihkan permukaan OEM side body panel dengan menggunakan lap bersih &amp; wash benzene dari debu dan minyak.</i></p>	
<p>2. Before install PLATE COMP FRONT,SCUFF and PLATE COMP REAR,SCUFF to OEM side body panel , release all liner tabing tape <math>\pm 30\%</math> and bend the liner to outward direction.</p> <p><i>2. Sebelum pasang PLATE COMP FRONT,SCUFF dan PLATE COMP REAR,SCUFF ke OEM side body panel , Lepas semua liner tabing tape <math>\pm 30\%</math> dan tekuk kearah luar.</i></p>	
<p>3. Install PLATE COMP FRONT,SCUFF base on Cover body panel line with use masking tape as datum for distance.</p> <p>( Distance from part to body cover line 61 mm and 32 mm )          ( Distance from part to Radius end 13 mm )</p> <p><i>3. Pasang PLATE COMP FRONT,SCUFF sesuai dengan Cover body panel line dengan menggunakan masking tape sebagai datum jarak.</i></p> <p>( Jarak antara part dengan body cover line 61 mm and 32 mm )          ( jarak antara part dengan End radius 13 mm )</p>	

<p>4. Release PLATE COMP FRONT,SCUFF tabing tape follow by number order, then push part carefully follow release direction tape.</p> <p>4. Lepas tabing tape PLATE COMP FRONT,SCUFF mengikuti urutan nomer, kemudian tekan part secara hati-hati mengikuti arah pelepasan tape.</p>	
<p>5. Install PLATE COMP REAR,SCUFF base on Cover body panel line with use masking tape as datum for distance.</p> <p>( Distance from part to body cover line 50 mm ) ( Distance from part to Radius end 11 mm )</p> <p>5. Pasang PLATE COMP REAR,SCUFF sesuai dengan Cover body panel line dengan menggunakan masking tape sebagai datum jarak.</p> <p>( Jarak antara part dengan body cover line 50 mm ) ( jarak antara part dengan End radius 11 mm )</p>	
<p>6. Release PLATE COMP REAR,SCUFF tabing tape follow by number order, then push part carefully follow release direction tape.</p> <p>6. Lepas tabing tape PLATE COMP REAR,SCUFF mengikuti urutan nomer, kemudian tekan part secara hati-hati mengikuti arah pelepasan tape.</p>	
<p>7. After finish installation, clean PLATE COMP FRONT,SCUFF and PLATE COMP REAR,SCUFF with clean cloth.</p> <p>7. Setelah selesai pemasangan, bersihkan install PLATE COMP FRONT,SCUFF and PLATE COMP REAR,SCUFF menggunakan lap yang bersih.</p>	